

DUROCK® SETTING-TYPE BASECOAT



FEATURES & BENEFITS

USG Middle East Durock® Basecoat is composed of Portland cement and dry latex polymers specially designed for exteriors walls, ceilings and DUROSCREEN™ 2100 System (EIFS, Exterior insulation and finishing system). It is prepared on site with water and applied with exterior tape Durock® brand reinforcement at joints between boards, inside and outside corners.

Meets or exceeds the following standards ASTM C472-79, C266-86, C109, EN 99E-1.

- For interior and exterior Durock® boards and cement boards applications.
- Specially formulated for Durock® system.
- High flexibility.
- Exceptional bond to the substrate.
- High performance designed for use in EIFS system.
- Asbestos-free product.



1ST COAT



2ND COAT



FINISHING
COAT



HAND &
MECHANICAL
TOOLS



PATCHING



SKIMMING



SANDING
RESISTIBILITY

COVERAGE

- As a coating of 2.5mm over the entire surface and joints treatment between boards of Durock® brand cement board, approximate Coverage - 7 to 8 square meter per bag.
- As a coating of 1.5mm over the entire surface and joints treatment between boards of Durock® brand cement board, approximate Coverage - 9 to 10 square meter per bag.
- As a bonding for insulating sheathing rigid extruded polystyrene or Stone Wool panel approximate Coverage - 12 to 14 square meters per bag.

USAGE

For joints treatment in Durock® system, neat finished edges, is used for embedding, as a coating over the entire surface and joints treatment between boards of Durock® brand cement board and edges that not required vinyl bead. For embedding fiberglass mesh and as a bonding for insulating sheathing density Stone Wool panels in EIFS (EIFS, Exterior insulation and finishing system) INSULCREEN™ 2100, for bonding Stone Wool panels on Durock® system and masonry systems.

APPROXIMATE SET TIME

- Set Time: 8 hours
- Cured concrete set time: 24 hours

LIMITATIONS

- Do not apply to frozen surfaces or containing ice.
- Do not apply if ambient temperature or surface temperature is less than 15°C.
- Do not left USG Middle East Durock® Basecoat as finishing, we recommend applying a sealer and finish.
- Do not apply basecoat on facades where there is risk of getting wet from the rain. Program the application to avoid the runoff and weathering of the fresh product.
- Check the finishing so it will be compatible with the cement surfaces.

STORAGE

- Store material in a cool, dry place. Avoid direct sunlight.
- Maintain temperature above 4°C.
- Shelf Life: Up to 24 months under protected storage conditions.
- Keep out moisture.
- Avoid dew point conditions or excessive moisture.
- After opening the bag close hermetic as possible.
- Stowing 60 bags maximum.

PREPARATION & APPLICATION

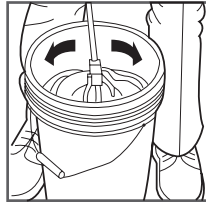

Place 5 liters of water in a container. Start the mixer; slowly add Basecoat and mix until to obtain a homogeneous mixture. Add more water if is necessary. Approximate water-cement ratios for Basecoat (hand or machine application) are 6 liters per bag. Mix plaster with a cage-type paddle driven by a heavy-duty drill capable of producing 300 to 450 rpm.

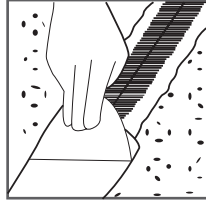

When the mixture is smooth and free of lumps, let stand 15 minutes, and then re-mix to a smooth paste. The surface where you will apply the cement must be completely clean, dry and free of dust, ice, grease, oil or other substances that may prevent adhesion.



Fill joints with Durock® Basecoat with a Hammer-End Joint Knife and then place the reinforcing exterior tape DUROCK® brand, troweling removing excess of Basecoat in order to embed the tape. Cover corners and vinyl beads. The thickness of the Durock® Basecoat must be thin, no more than 1 mm. Remove excess with a flat metal wool or polystyrene wet. Allow dry at least 4 hours.

Once the joints are dry, apply a uniform layer of 2 mm thick over the entire surface of Basecoat Durock® brand with a flat trowel. Allow dry at least 24 hours before applying any seal or finish.

GOOD PRACTICES

- Stir occasionally during use to maintain a smooth, manageable texture. The working time is about 3 hours.
- In hot and dry climates, you can moisten the surface of cement board before applying uniform layer to slow the drying time of compound and avoid possible cracks.
- The mesh should not be visible through the Durock® Basecoat.
- Maximum thickness recommended should be 3 mm across the surface.
- Before the Basecoat is dry, you can smooth the texture with a wet float.
- Allow dry at least 24 hours before applying the finish.

PRODUCT DATA

Color: dry to grey

Working Time: 8 hours to dry

Packaging: 25kg bag

Shelf life: 24 months

SECURITY

To handle and apply Durock® Basecoat, we recommend the following safety equipment:

- Mask to protect nose and mouth to prevent dust inhalation.
- Safety glasses for protection during cement application.
- Gloves, the alkalinity of the product can irritate the skin if the contact is prolonged.
- Hard hat, Steel-Toe boots, tool belt are some of the accessories required to work on site.

SAFETY

Dust may cause irritation to eyes, skin, nose, throat and upper respiratory tract. Avoid irritation by reducing exposure to dust. Use in a well-ventilated area or provide sufficient local ventilation.

Follow good safety/industrial hygiene practices during installation. Wear appropriate personal protective equipment.

REFERENCES

For further health and safety instructions, refer to the Safety Data Sheet (SDS) for this product, available from your USG Middle East sales office or **USGme.com**

Notice:

As we are involved in constant products development; this document information is subject to change without prior notice. Please always refer to **usgme.com** for the updated products information document.

©2022 Factory of USG Middle East LTD. Co. All rights reserved.