

# GENERAL PURPOSE SETTING-TYPE BASECOAT



## FEATURES & BENEFITS

General Purpose Setting-Type Basecoat is composed of Portland cement and dry latex polymers specially designed for exteriors walls, ceilings system (EIFS, Exterior insulation and finishing system). It is prepared on site with water and applied with exterior tape brand reinforcement at joints between boards, inside and outside corners. Meets the following standards ASTM C472-79, C266-86, C109-84, EN 99E-1.

- For interior and exterior applications.
- Specially formulated for cement board system.
- High flexibility.
- Good bonding to the substrate.
- Designed for use in EIFS systems.
- Asbestos-free product.



1<sup>ST</sup> COAT



2<sup>ND</sup> COAT



FINISHING  
COAT



HAND &  
MECHANICAL  
TOOLS



PATCHING



SKIMMING



SANDING  
RESISTIBILITY

## COVERAGE

- As a coating of 2.5 mm. over the entire surface and joints treatment between boards of cement board, approximate Coverage - 7 to 8 square meter per bag.
- As a coating of 1.5 mm. over the entire surface and joints treatment between boards of cement board, approximate Coverage - 9 to 10 square meter per bag.
- As a bonding for insulating sheathing rigid extruded polystyrene, approximate Coverage - 12 to 14 square meters per bag.

## USAGE

For joints treatment in Cement Board, neat finished edges, is used for embedding, as a coating over the entire surface and joints treatment between boards of cement board and edges that not required vinyl bead. For embedding fiberglass mesh.

## APPROXIMATE SET TIME

Set Time: 8 hours  
Cured concrete set time: 24 hours

## LIMITATIONS

- Do not apply to frozen surfaces or containing ice.
- Do not apply if ambient temperature or surface temperature is less than 13 ° C.
- Do not left General Purpose Basecoat as finishing, we recommend applying a sealer and finish.
- Do not apply General Purpose Basecoat on facades where there is risk of getting wet from the rain. Program the application to avoid the runoff and weathering of the fresh product.
- Check the finishing so it will be compatible with the cement surfaces.

## STORAGE

- Store material in a cool, dry place. Avoid direct sunlight.
- Maintain temperature above 4 °C.
- Shelf Life: Up to 24 months under protected storage conditions.
- Keep out moisture.
- Avoid dew point conditions or excessive moisture.
- After opening the bag close hermetic as possible.
- Stowing 60 bags maximum.

## PREPARATION & APPLICATION

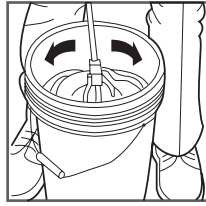

Place 5 liters of water in a container. Start the mixer; slowly add USG General Purpose Basecoat and mix until to obtain a homogeneous mixture. Add more water if is necessary. Approximate water-cement ratios for Basecoat (hand or machine application) are 6 liters per bag. Mix plaster with a cage-type paddle driven by a heavy-duty drill capable of producing 300 to 450 rpm.

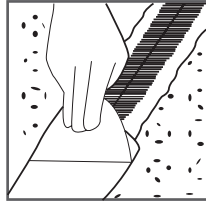

When the mixture is smooth and free of lumps, let stand 15 minutes, and then re-mix to a smooth paste. The surface where you will apply the cement must be completely clean, dry and free of dust, ice, grease, oil or other substances that may prevent adhesion.



Fill joints with General Purpose Basecoat with a Hammer-End Joint Knife and then place the reinforcing exterior tape, retroweling removing excess of Basecoat in order to embed the tape. Cover corners and vinyl beads. The thickness of the General Purpose Basecoat must be thin, no more than 1 mm. Remove excess with a flat metal wool or polystyrene wet. Allow dry at least 4 hours.

Once the joints are dry, apply a uniform layer of 2 mm thick over the entire surface of Basecoat with a flat trowel. Allow dry at least 24 hours before applying any seal or finish.

## GOOD PRACTICES

- Stir occasionally during use to maintain a smooth, manageable texture. The working time is about 3 hours
- In hot and dry climates, you can moisten the surface of cement board before applying uniform layer to slow the drying time of compound and avoid possible cracks.
- The mesh should not be visible through the Basecoat.
- Maximum thickness recommended should be 3 mm across the surface.
- Before the Basecoat is dry, you can smooth the texture with a wet float.
- Allow dry at least 24 hours before applying the finish.

## PRODUCT DATA

**Color:** dry to white  
**Working Time:** 8 hours to dry  
**Packaging:** 25kg bag  
**Shelf life:** 24 months

## SECURITY

- To handle and apply Basecoat, we recommend the following safety equipment:
- Mask to protect nose and mouth to prevent dust inhalation.
- Safety glasses for protection during cement application.
- Gloves, the alkalinity of the product can irritate the skin if the contact is prolonged.
- Hard hat, Steel-Toe boots, tool belt are some of the accessories required to work on site.

## SAFETY

Dust may cause irritation to eyes, skin, nose, throat and upper respiratory tract. Avoid irritation by reducing exposure to dust. Use in a well-ventilated area or provide sufficient local ventilation.

Follow good safety/industrial hygiene practices during installation. Wear appropriate personal protective equipment.

## REFERENCES

For further health and safety instructions, refer to the Safety Data Sheet (SDS) for this product, available from your USG Middle East sales office or **USGme.com**

### Notice:

As we are involved in constant products development; this document information is subject to change without prior notice. Please always refer to **usgme.com** for the updated products information document.

©2022 Factory of USG Middle East LTD. Co. All rights reserved.